

CATÁLOGO

MATRIZES DE CORTE FABRICADAS EM AÇO

Desenvolvidas para a extração precisa de corpos de prova em materiais como plásticos, papéis, tecidos e borrachas

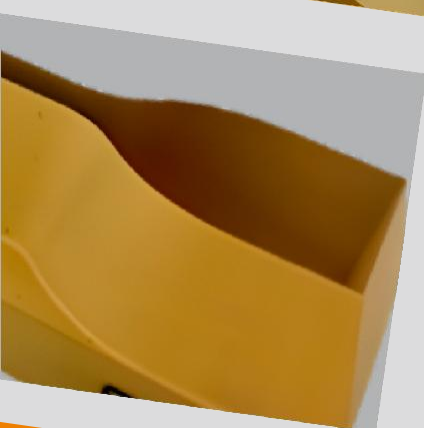
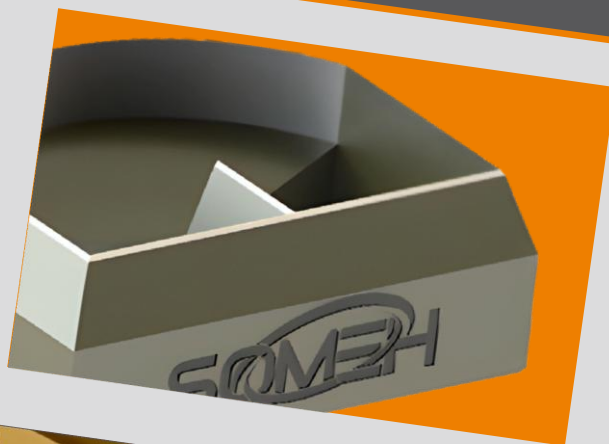
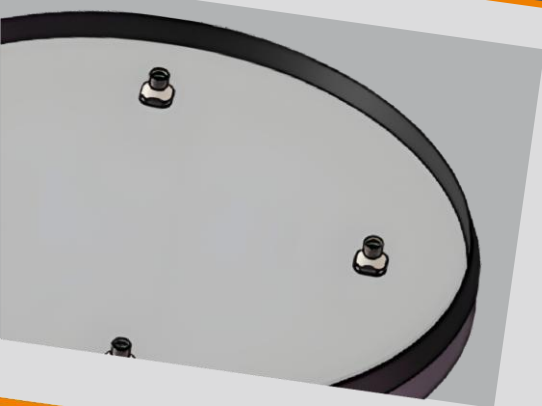

Lista de Norma

- Caso sua norma não esteja listada aqui pode nos solicitar.
- Fabricamos cunhos de corte personalizados.
- Outras dimensões estão disponíveis sobre consulta.

✓ NBR 15557 tipo I	✓ DIN53504	✓ JIS K6301-Type 1	✓ ASTM-D1922
✓ ASTM D 4833	✓ NBR 60903 fig. 4	✓ K6251	✓ ASTM D3574 – Type F
✓ ASTM D 5397	✓ NBR 16548 - tipo R	✓ ISO 1798 tipo 1A	✓ DIN ISO34-1
✓ NBR 12236	✓ ISO 37 – Type 3	✓ ASTM D1708	✓ SO 6259-3 tipo 3
✓ ASTM D638-02a-Type 4	✓ /NZS 1660.2.3	✓ ASTM D2116	✓ SO 527-2 – Type 1BA
✓ ASTM D6693"	✓ DIN 53504	✓ ASTM D4894	✓ ASTM D471 10.1
✓ K6301- B	✓ ISO 8256 tipo 3	✓ ASTM D4895	✓ NBR 9952-2014
✓ ASTM D624 – Type C	✓ ASTM D412-C	✓ JIS K7137-2-A	✓ D45 1231
✓ ASTM D1004-03	✓ ISO 6259-3-Type 2	✓ JIS K6935-2	✓ D41 1048
✓ DIN ISO34-1	✓ K6251-Type 5	✓ ISO 179; ISO 180	✓ NBR 16548 - tipo F
✓ NBR 8516	✓ ISO 37 – Type 1	✓ ISO 37 – Type 4	✓ NBR 15725
✓ ASTM D 4533	✓ ISO 37-1 Type 2	✓ ISO 527-2 – Type 5B	✓ SO 1798 tipo 1
✓ NBR 15557 tipo II	✓ ISO 527-3 – Type 5	✓ ISO 6892 B1 tipo 2	✓ ASTM D412 Tipo A
✓ NBR 8515	✓ BS 2782-3 (Method 320A)	✓ ASTM D638-02a-Type 5	✓ ASTM D412 Tipo B
✓ ISO 37-Type 2	✓ AS 1145.3 – Type 5	✓ ASTM D1822-Type L	✓ ASTM D412 Tipo F
✓ ISO 527-2-Type 5A	✓ DIN53504	✓ NBR 10622	✓ ASTM D822
✓ AS 1145-Type 5A	✓ ASTM D882	✓ ISO 527-2 – Type 1A	✓ ASTM D1938
✓ K6251-Type 6	✓ NBR 10591	✓ ISO 527-2 – Type 1B	✓ SO 527-2 – Type 1BB
✓ AS/NZS 1660.2.3	✓ ASTM D638-10 Tipo I	✓ ISO 527-3 – Type 1B	✓ DIN ISO 34-1
✓ DIN53504	✓ ASTM D638-10 Tipo III	✓ BS 2782-3 (Method 320B)	✓ K6301-Type A
✓ NBR 60903 fig. 4	✓ ASTM D638-10 Tipo II	✓ BS 2782-10 – Type 1	✓ ASTM D624 – Type B
✓ NBR 16548 - tipo R	✓ JIS K6301-Type 3	✓ ISO 6259-3 Type 1	✓ ISO 283 Tipo B
✓ FCA 50405-02	✓ K6251- Type 3	✓ NBR 13321 fig.4	✓ SO 283 Tipo C
✓ ISO 37-Type 2	✓ ISO 37 – Type 1A	✓ NBR 16548 - tipo I	✓ JIS K6301-Type 4
✓ ISO 527-2-Type 5A	✓ ASTM D 3182	✓ MS200-41 tipo 2	✓ ASTM D1822-Type L
✓ AS 1145-Type 5A	✓ ASTM E8M	✓ ASTM D790	✓ ASTM D1822-Type S
✓ K6251-Type 6	✓ NBR 10591	✓ ASTM D412 Tipo D	✓ ASTM D3574 – Type E
✓ AS/NZS 1660.2.3	✓ ASTM D882	✓ ASTM D412 tipo E	✓ SO 527-3 – Type 4

Matrizes

CUNHOS DE CORTE PARA PREPARAÇÃO DE CORPOS DE PROVA



As matrizes de corte fabricadas em aço ferramenta, fornecidas pela SOMEH, são desenvolvidas para a extração precisa de corpos de prova em materiais como plásticos, papéis, tecidos e borrachas. Esses dispositivos podem ser utilizados em conjunto com prensas de corte da própria SOMEH, garantindo padronização e eficiência no preparo das amostras para ensaios laboratoriais.

CARACTERÍSTICAS

- Dimensões customizada;
- Certificado de calibração;
- Pintura com Cerakote;
- Gravação a laser;
- Pode ser reafiada;
- Vida útil maior do réguas de corte;
- Extremidade temperada;
- Material especial para corte;
- Formato gravata;
- Formato tipo angulo;
- Formato retangular;
- Formato redondo;
- Formato especial.

APLICAÇÃO

- Papelão
- Espuma
- Papel
- Plástico
- Borracha
- Polimeros



Corte manual

Até 0,5ton.



Corte hidráulica

Até 30ton.



Corte pneumática

Até 2,5ton.

SOH 1325-015

PARÂMETROS TÉCNICOS



- ISO 37-Tipo 2
- ISO 527-2-Tipo 5A
- AS 1145-Tipo 5A
- K6251-Tipo 6
- AS/NZS 1660.2.3
- DIN53504
- IEC 60811-1-1 fig.12
- IEC 60903 fig. 4
- IEC 16548 – tipo R
- 75 x 12,5 x 4mm

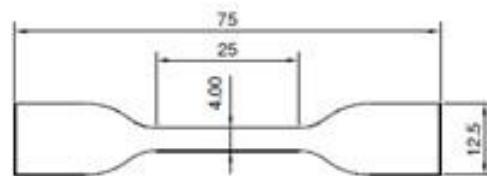

SOH 1325-018

PARÂMETROS TÉCNICOS



- ASTM D412-C
- ISO 6259-3 tipo 2
- K6251-Tipo 5
- ISO 37 – Tipo 1
- ISO 37-1 Tipo 2
- ISO 527-3 – Tipo 5
- BS 2782-3 (Método 320A)
- AS 1145.3 – Tipo 5
- DIN53504
- ASTM D882
- 115 x 25 x 6mm

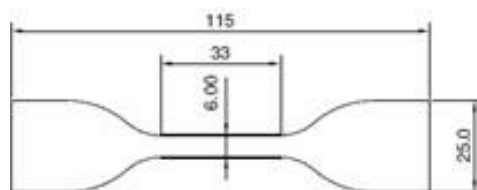

SOH 1325-056

PARÂMETROS TÉCNICOS



- ASTM D412-D
- 100 x 16 x 3mm

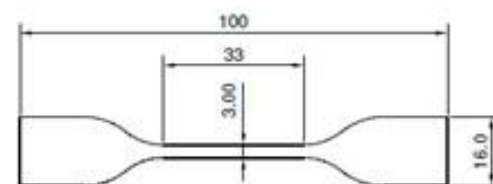

SOH 1325-024

PARÂMETROS TÉCNICOS



- JIS K6301-Tipo 3
- K6251- Tipo 3
- ISO 37 – Tipo 1^a
- 100 x 25 x 5mm

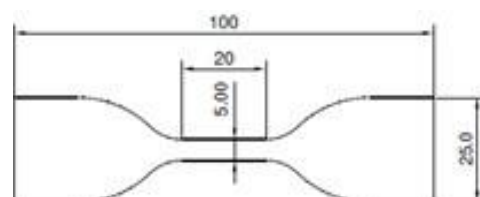

SOH 1325-005

PARÂMETROS TÉCNICOS



- IASTM D638-02a-Tipo 4
- ASTM D6693
- 115x 19 x 6mm

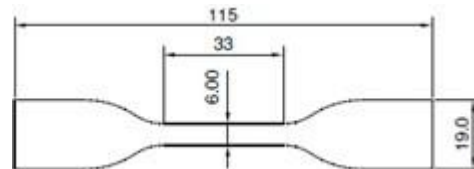

SOH 1325-034

PARÂMETROS TÉCNICOS



- JIS K6301-Tipo 1
- K6251
- ISO 1798 tipo 1A
- 120 x 25 x 10mm

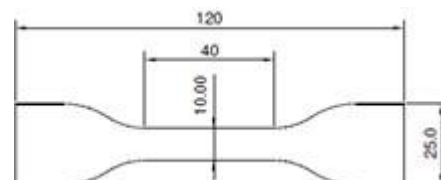

SOH 1325-053

PARÂMETROS TÉCNICOS



- MS200-41 tipo 2
- JIS K6301-Type 2
- 100 x 25 x 10mm

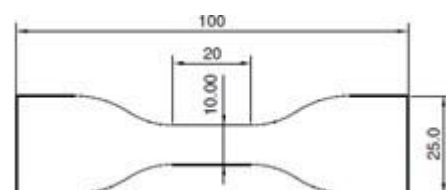

SOH 1325-097

PARÂMETROS TÉCNICOS



- JIS K6301-Tipo 4
- 100 x 15 x 5mm

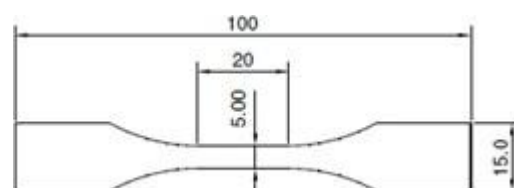

SOH 1325-016

PARÂMETROS TÉCNICOS



- ISO 37 – Tipo 3
- AS/NZS 1660.2.3
- DIN 53504
- 50 x 8,5 x 4 mm

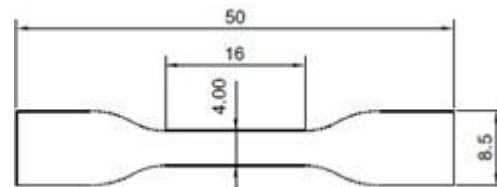

SOH 1325-041

PARÂMETROS TÉCNICOS



- ISO 37 – Type 4
- ISO 527-2 – Type 5B
- 35 x 6 x 2mm

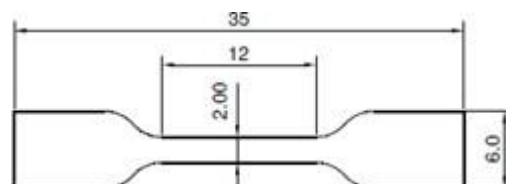

SOH 1325-006

PARÂMETROS TÉCNICOS



- K6301- B
- ASTM D624 – Tipo C
- ASTM D1004-03
- DIN ISO34-1
- NBR 8516
- 101,6 x 19 mm

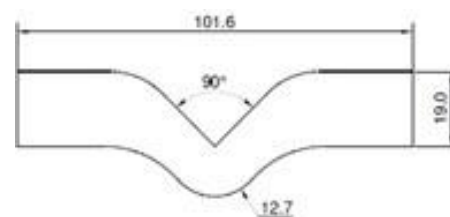

SOH 1325-020

PARÂMETROS TÉCNICOS



- ASTM D638-10 Tipo I
- 165 x 19 x 13mm

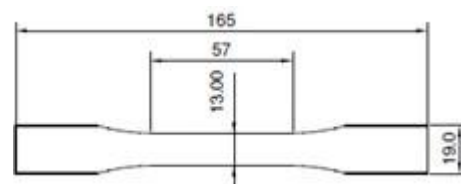

SOH 1325-023

PARÂMETROS TÉCNICOS



- ASTM D638-10 Tipo II
- 183 x 19 x 6mm

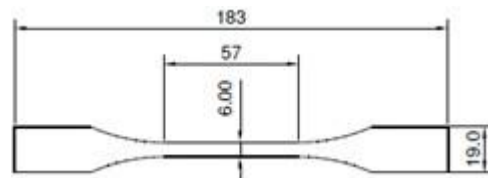

SOH 1325-021

PARÂMETROS TÉCNICOS



- ASTM D638-10 Tipo III
- 246 x 29 x 19mm

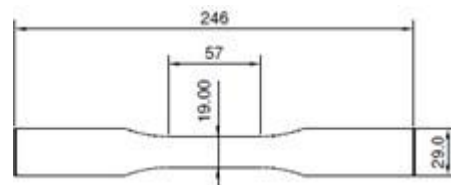

SOH 1325-035

PARÂMETROS TÉCNICOS



- ASTM D1708
- ASTM D2116
- ASTM D4894
- ASTM D4895
- JIS K7137-2-A
- JIS K6935-2
- 38 x 15 x 5mm

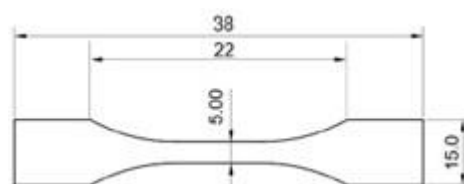

SOH 1325-090

PARÂMETROS TÉCNICOS



- DIN ISO 34-1
- K6301-Tipo A
- ASTM D624 – Tipo
- 110 x 25 x 10,2mm

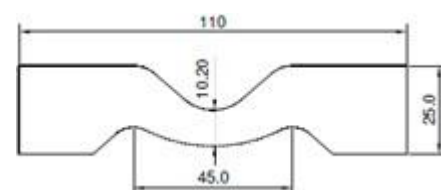

SOH 1325-045

PARÂMETROS TÉCNICOS



- ASTM D638-02a-tipo 5
- ASTM D1822-Type L
- 63,5 x 9,53 x 3,18mm

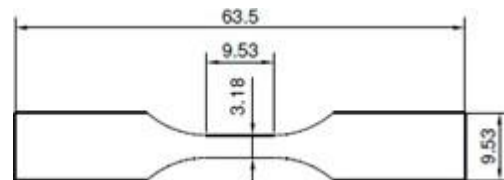

SOH 1325-098

PARÂMETROS TÉCNICOS



- ASTM D1822-Type L
- 63,5 x 12,7 x 3,18mm

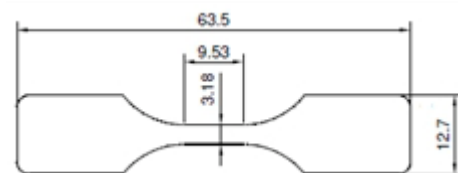

SOH 1325-089

PARÂMETROS TÉCNICOS



- ASTM D1822-Type S
- 63,5 x 9,53 x 3,18mm

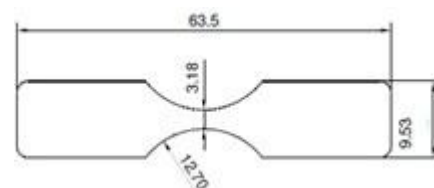

SOH 1325-094

PARÂMETROS TÉCNICOS



- NBR 8067
- 100 x 19mm

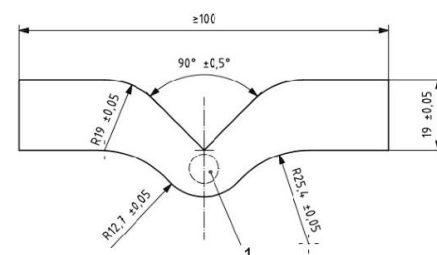

SOH 1325-099

PARÂMETROS TÉCNICOS



- ASTM D3574 – Type E
- 139,7 x 25,4 x 12,7



SOH 1325-065

PARÂMETROS TÉCNICOS



- ASTM D3574 – Type F
- DIN ISO34-1
- 152,4 x 25,4

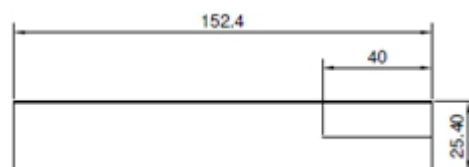

SOH 1325-050

PARÂMETROS TÉCNICOS



- ISO 527-2 – Tipo 1A
- 150 x 20 x 10mm

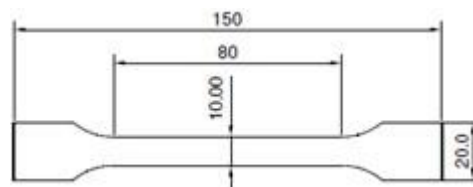

SOH 1325-051

PARÂMETROS TÉCNICOS



- ISO 527-2 – Tipo 1B
- ISO 527-3 – Tipo 1B
- BS 2782-3 (Método 320B)
- BS 2782-10 – Tipo 1
- ISO 6259-3 Tipo 1
- NBR 13321 fig.4
- 150 x 20 x 10mm

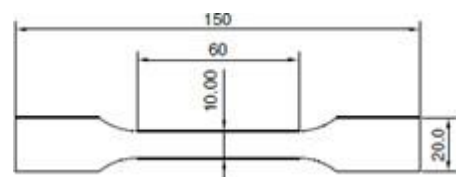

SOH 1325-068

PARÂMETROS TÉCNICOS



- ISO 527-2 – Tipo 1BA
- 75 x 10 x 5mm

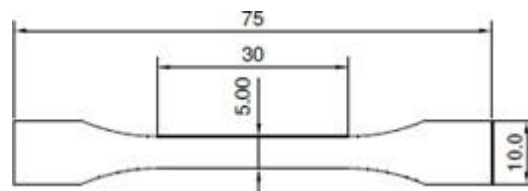

SOH 1325-088

PARÂMETROS TÉCNICOS



- ISO 527-2 – Tipo 1BB
- 30 x 4 x 2mm

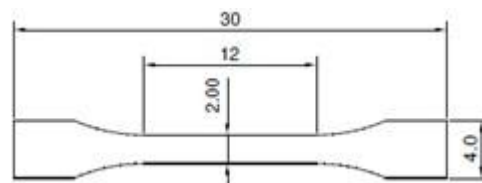

SOH 1325-037

PARÂMETROS TÉCNICOS



- ISO 527-3 – Tipo 2
- AS 1145.3 – Tipo 2
- 150 x 10 ou 25mm

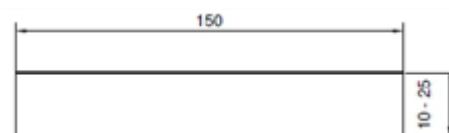

SOH 1325-096

PARÂMETROS TÉCNICOS



- ISO 527-3 – Type 4
- 152 x 38 x 25,4mm

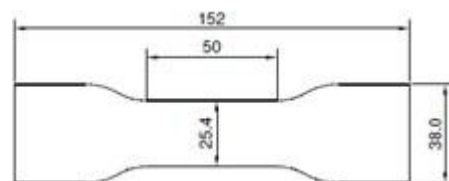

SOH 1325-081

PARÂMETROS TÉCNICOS



- ASTM D412 Tipo A
- 140 x 25 x 12mm

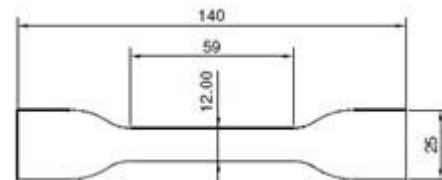

SOH 1325-082

PARÂMETROS TÉCNICOS



- ASTM D412 Tipo B
- 140 x 25 x 6mm

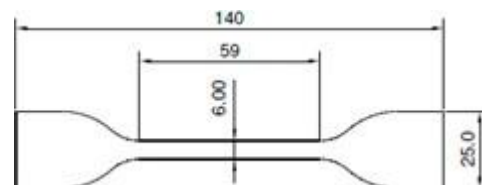

SOH 1325-057

PARÂMETROS TÉCNICOS



- ASTM D412 Tipo E
- 125 x 16 x 3mm

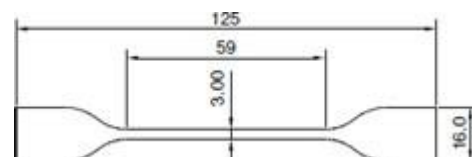

SOH 1325-083

PARÂMETROS TÉCNICOS



- ASTM D412 Tipo F
- 125 x 16 x 6mm

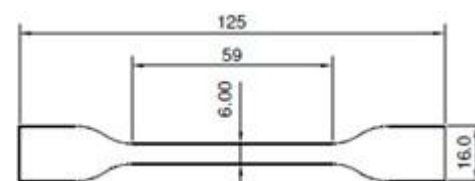

SOH 1325-079

PARÂMETROS TÉCNICOS



- ISO 1798 tipo 1
- 152 x 25 x 13mm

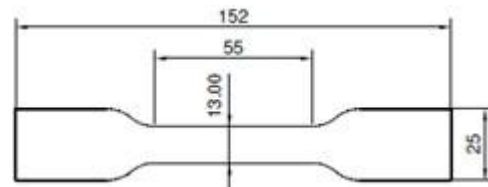

SOH 1325-001

PARÂMETROS TÉCNICOS



- NBR 15557 tipo I
- 113 x 26 x 6mm

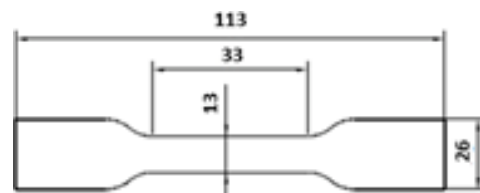

SOH 1325-003

PARÂMETROS TÉCNICOS



- ASTM D 5397
- 60 x 12,7 x 3,2mm

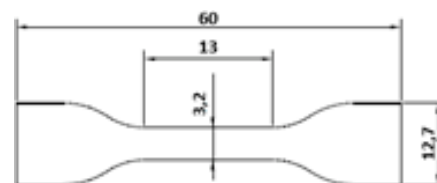

SOH 1325-010

PARÂMETROS TÉCNICOS



- NBR 8515
- 140 x 25,4 x 12,7mm

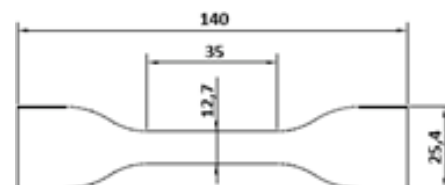

SOH 1325-014

PARÂMETROS TÉCNICOS



- FCA 50405-02I
- 140 x 25 x 10 mm

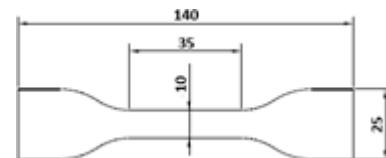

SOH 1325-017

PARÂMETROS TÉCNICOS



- ISO 8256 tipo 3
- 80 x 15 x 10mm

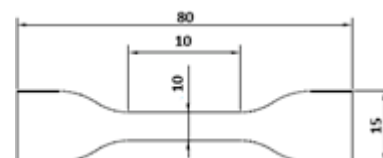

SOH 1325-027

PARÂMETROS TÉCNICOS



- ASTM E8M
- 100 x 10 x 6 mm

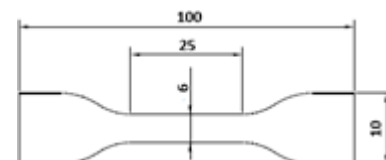

SOH 1325-033

PARÂMETROS TÉCNICOS



- ASTM D882
- 80 x 10 x 4 mm

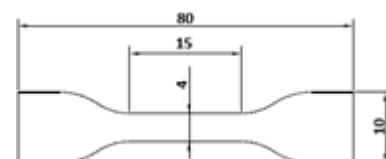

SOH 1325-049

PARÂMETROS TÉCNICOS



- NBR 10622
- 155 x 25 x 6mm

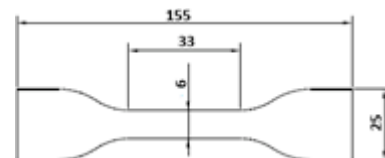

SOH 1325-066

PARÂMETROS TÉCNICOS

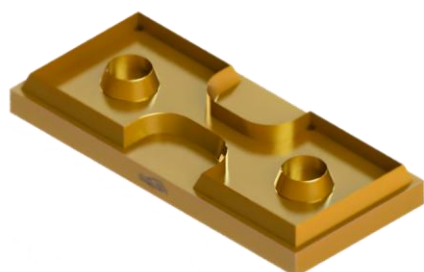

- ISO 6259-3 tipo 3
- 250 x 100 x 25mm

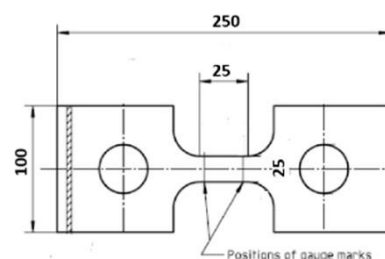

SOH 1325-071

PARÂMETROS TÉCNICOS



- D45 1231
- 152 x 10 x 4mm

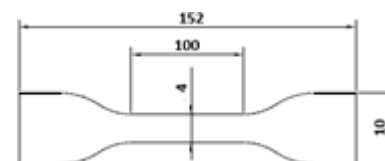

SOH 1325-074

PARÂMETROS TÉCNICOS



- NBR 16548 - tipo F
- 100 x 11 x 4mm

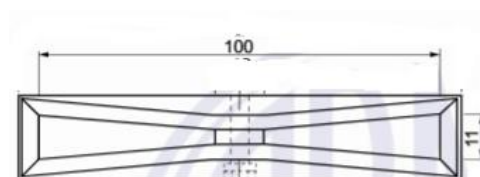

SOH 1325-077

PARÂMETROS TÉCNICOS



- NBR 15725
- 75 x 8,5 x 4mm

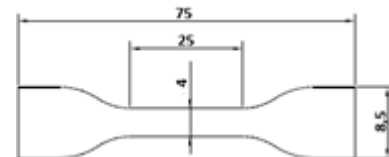

SOH 1325-092

PARÂMETROS TÉCNICOS



- ISO 283 Tipo B
- 415 x 100 x 25mm

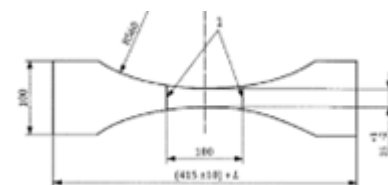

SOH 1325-093

PARÂMETROS TÉCNICOS



- ISO 283 Tipo C
- 240 x 63 x 25mm

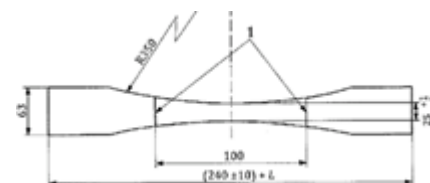

SOH 1325-002

PARÂMETROS TÉCNICOS



- ASTM D 4833
- Ø100mm

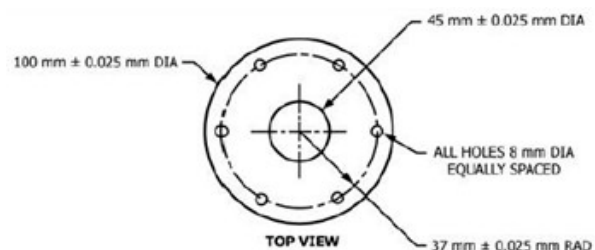

SOH 1325-004

PARÂMETROS TÉCNICOS



- NBR 12236
- Ø300mm

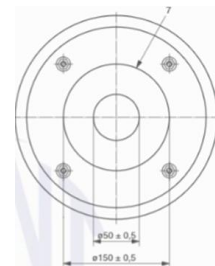

SOH 1325-019

PARÂMETROS TÉCNICOS

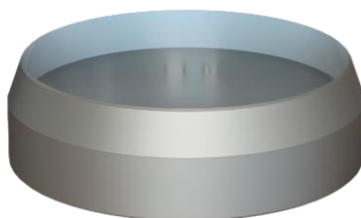

- NBR 10591
- Ø112,8mm

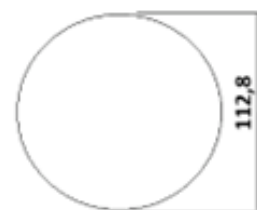

SOH 1325-007

PARÂMETROS TÉCNICOS

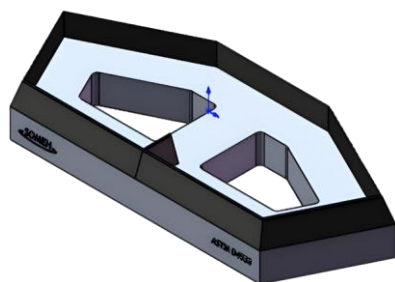

- ASTM D 4533
- 77,2 x 189,2mm

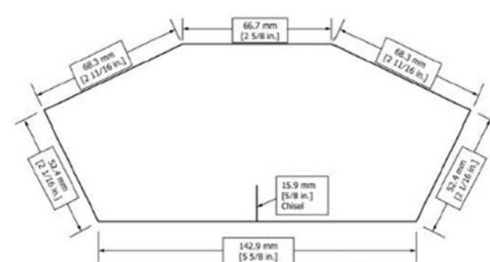

FIG. 3 Optional Trapezoidal Template for Trapezoid Tearing Strength Test

SOH 1325-008

PARÂMETROS TÉCNICOS



- NBR 15557 tipo II
- 100 x 19 mm

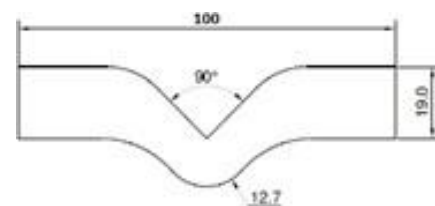

SOH 1325-062

PARÂMETROS TÉCNICOS



- ASTM-D1922
- 73 x 63mm

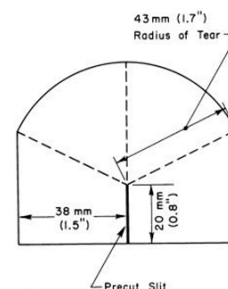

SOH 1325-072

PARÂMETROS TÉCNICOS



- D41 1048
- 125 x 25mm

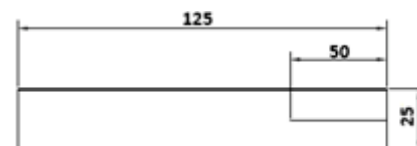

SOH 1325-085

PARÂMETROS TÉCNICOS



- ASTM D1938
- 75 x 25 mm

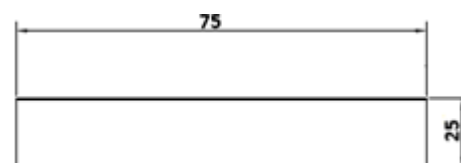

SOH 1325-012

PARÂMETROS TÉCNICOS



- NBR 15557 tipo II
- 100 x 19 mm

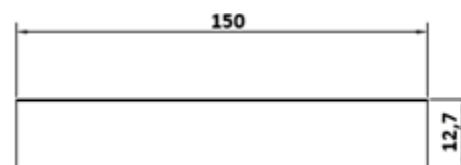

SOH 1325-028

PARÂMETROS TÉCNICOS



- Especial
- 100 x 25mm

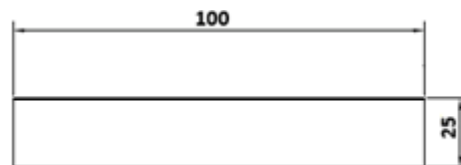

SOH 1325-029

PARÂMETROS TÉCNICOS



- Especial
- 100 x 50mm

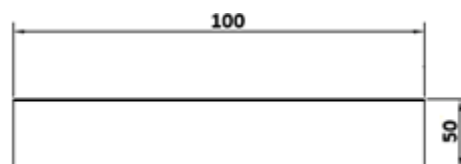

SOH 1325-031

PARÂMETROS TÉCNICOS



- Especial
- 125 x 25mm

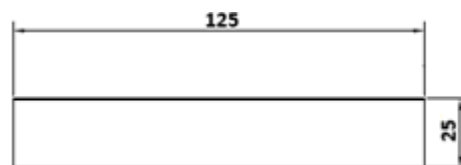

SOH 1325-038

PARÂMETROS TÉCNICOS



- ISO 179; ISO 180
- 80 x 10mm

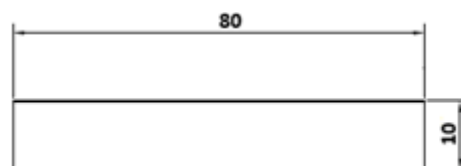

SOH 1325-055

PARÂMETROS TÉCNICOS



- ASTM D790
- 125 x 12,7

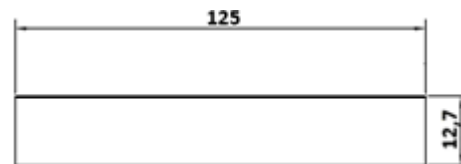

SOH 1325-063

PARÂMETROS TÉCNICOS



- Especial
- 150 x 75mm

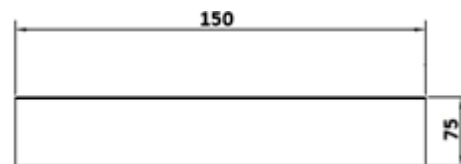

SOH 1325-070

PARÂMETROS TÉCNICOS



- NBR 9952-2014
- 300 x 50 mm

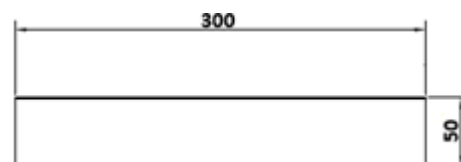

SOH 1325-084

PARÂMETROS TÉCNICOS



- ASTM D822
- 300 x 25mm

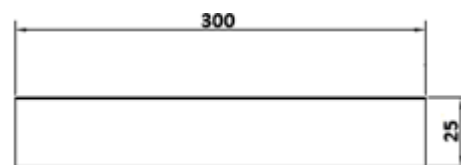

SOH 1325-030

PARÂMETROS TÉCNICOS



- NBR 10591
- 100 x 100mm

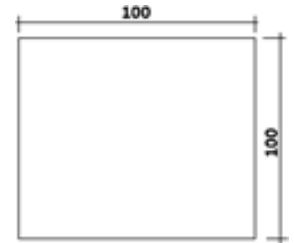

SOH 1325-039

PARÂMETROS TÉCNICOS



- Especial
- 50 x 50 mm

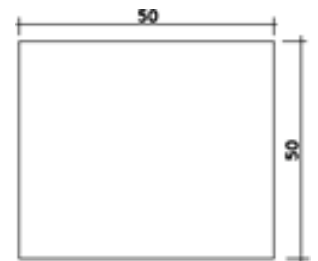

SOH 1325-100

PARÂMETROS TÉCNICOS



- NBR 16548 - tipo I
- 115 x 26 x 6mm

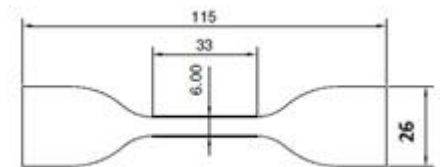



www.someh.com.br

SOMEH

PROJETOS, PRODUTOS E SERVIÇOS



Araquari · Santa Catarina · Brasil +55 47 **3202.7221**
comercial@someh.com.br